



**TATA**

Tata Steel International (Australasia) Ltd

---

# Tube & Tube Fittings

---

Stainless Steel

**TATA STEEL**

# SECTION C

## Contents

Tube – Round/Square/Rectangular	Pages	C1 - C2
Tube – Deco – Structural	Page	C3
Spiral Welded Tube/Pipe	Page	C4
Handrail Accessories	Page	C5
Tube Bends	Pages	C6 - C7
ABE – Pressed Elbows	Pages	C8 - C9
Tube Reducers, Tees	Page	C10
Tri-Fittings	Page	C11
CIP (Clean in Place) Dairy Fittings	Pages	C12 - C13
Tube Hangers	Page	C14
Expansion Flanges	Page	C15

# STAINLESS STEEL ROUND TUBE

Manufactured to ASTM A269/A270 (Food/hygienic applications)

SIZE (O/D) (mm)	WALL THICKNESS	THEORETICAL WEIGHT Kg/Mtr	T304		T316		2205	EXHAUST TUBING	DOMESTIC WATER
			POL	AW	POL	AW	AW	409AW	TUBE AW
6.3	0.7	0.098							
6.3	0.9	0.122	•						
7.9	0.9	0.158	•						
9.5	0.9	0.194	•						
9.5	1.2	0.250	•		•				
12.7	0.9	0.276	•						
12.7	1.2	0.346	•		•				
12.7	1.6	0.445	•		•				
14.7	0.7	0.254							
14.7	0.9	0.315							•
15.8	0.9	0.341	•						
15.8	1.2	0.445	•		•				
15.8	1.6	0.577	•		•				
19.0	0.9	0.408	•						
19.0	1.2	0.542	•		•				
19.0	1.6	0.697	•		•				
22.1	0.9	0.482	•						
22.1	1.2	0.638	•						
22.1	1.5	0.825	•						
25.4	0.9	0.552	•						
25.4	1.2	0.735	•						
25.4	1.6	0.965	•		•	•			
31.8	0.9	0.697	•						
31.8	1.2	0.920	•						
31.8	1.6	1.210	•		•	•			
38.1	0.9	0.836	•						
38.1	1.2	1.106	•						
38.1	1.6	1.458	•		•	•	•		
44.5	1.2	1.301	•					•	
44.5	1.6	1.719	•		•			•	
50.8	1.2	1.496	•						
50.8	1.6	2.000	•		•	•		•	
50.8	2.0	2.447	•						
63.5	1.2	1.872	•						
63.5	1.6	2.480	•		•	•			
76.1	1.6	2.984	•		•	•			
88.9	1.6	3.680		•					
101.6	1.6	4.005	•		•	•			
101.6	2.0	4.995	•						
152.0	1.6	5.910	•		•	•			
152.0	2.0	8.333	•		•				

SOME SIZES ARE NOT STOCKED BUT ARE AVAILABLE ON INDENT

STANDARD LENGTH – 6.0 METRES

“L” GRADE CAN BE SUPPLIED ON REQUEST IN BOTH T304 AND T316 ROUND OR SQUARE TUBE

FINISH: A/W – As welded – Weld area only finished

POL – Buff Polished – Surface finished to 180 grit and buff polished. Other finishes available on request.

# STAINLESS STEEL SQUARE TUBE

Manufactured to ASTM A554 (6 METRE LENGTHS) (Structural applications only)

SIZE (O/D) (mm)	WALL THICKNESS	WEIGHT Kg/Mtr	T304		T316	
			POL	AW	POL	AW
<b>SQUARE</b>						
12.7 x 12.7	1.2	0.468	•			
19.0 x 19.0	1.2	0.672	•			
19.0 x 19.0	1.5	0.881	•			
25.4 x 25.4	1.2	0.920	•			
25.4 x 25.4	1.5	1.210	•		•	
31.8 x 31.8	1.2	1.118	•			
31.8 x 31.8	1.5	1.868	•	•	•	
35.0 x 35.0	1.5	1.770	•			
38.1 x 38.1	1.2	1.412	•	•		
38.1 x 38.1	1.5	1.868	•		•	
40.0 x 40.0	2.0	2.560	•			
50.8 x 50.8	1.5	2.487	•		•	
50.8 x 50.8	2.0	3.264	•			
50.8 x 50.8	3.0	4.870	•			
60.0 x 60.0	2.0	3.840	•			
60.0 x 60.0	3.0	5.760	•			
76.2 x 76.2	1.5	3.630	•	•		
76.2 x 76.2	2.0	4.742	•	•		
76.2 x 76.2	4.5	11.360		•		
80.0 x 80.0	2.0	5.120	•	•		
80.0 x 80.0	3.0	7.680	•		•	
100.0 x 100.0	3.0	9.600	•			
101.6 x 101.6	4.5	15.040		•		
152.4 x 152.4	4.5	22.000		•		

## R.H.S

40.0 x 20.0	1.5	1.360	•			
40.0 x 20.0	2.0	1.920	•			
51.0 x 25.4	1.5	1.868	•	•	•	
80.0 x 40.0	2.0	3.840	•			
80.0 x 40.0	3.0	5.760	•			
100.0 x 50.0	3.0	7.200	•			

**FINISHES: AW – AS WELDED – WELD AREA ONLY LISHED**  
**POL – POLISHED – ARCHITECTURAL FINISH (180 GRIT)**

# STAINLESS STEEL “DECO” ROUND TUBE

Manufactured to ASTM A554

SIZE (O/D) (mm)	WALL THICKNESS (mm)	THEORETICAL WEIGHT Kg/Mtr	T304 DECO Brite Polish (600 grit)*	T316 DECO Brite Polish (600 grit)*
15.88	1.2	0.445	•	
15.88	1.5	0.577	•	
19.0	1.2	0.542	•	
19.0	1.5	0.697	•	•
22.2	1.2	0.631	•	
22.2	1.5	0.825	•	
25.4	1.2	0.735	•	
25.4	1.5	0.965	•	•
31.8	1.5	1.210	•	•
38.1	1.5	1.458	•	•
44.5	1.5	1.719	•	•
50.8	1.5	2.000	•	•
63.5	1.5	2.480	•	
76.2	1.5	2.984	•	
101.6	1.5	4.005	•	

Available ex stock in 6 metre lengths

\*Deco Ultrabrite (mirror - like polish) option available.

**NB** For structural applications only. Do not use for conveying food, beverages, sanitary products, liquids or gas. For these applications refer to tube on page C1.

# STAINLESS STEEL “DECO” REBATE TUBE

FOR GLASS BALUSTRADE APPLICATIONS



SIZE(OD) (mm)	WALL THICKNESS (mm)	PROFILE	THEORETICAL WEIGHT (kg/m)	T316 400 grit polish	T316 DECO UltraBrite polish (mirror-like polish)
50.80	1.50	Single rebate	2.000	•	•
50.80	1.50	Double rebate	2.000	•	•

Available ex stock in 6 metre lengths. Rebate dimension = 15 x 15mm

## OTHER STAINLESS STEEL TUBE PROFILES

Also available strictly to order



# SPIRAL WELDED

## T304/T316

NOMINAL mm	PIPE DIAMETER TRUE DIAMETER		WALL THICKNESS APPROXIMATELY		WEIGHT PER METRE Approx. kgs	WORKING PRESSURE	
	mm	inches	mm	swg		mpa	psi
80	76.2	3"	2.0	14	3.9	4.6	667
			3.0	11	5.9	6.9	1000
100	101.6	4"	2.0	14	5.2	3.6	522
			3.0	11	7.8	5.2	754
125	127.0	5"	1.5	16	5.1	4.2	609
			2.0	14	6.4	2.8	406
			3.0	11	9.8	8.4	1218
150	152.4	6"	1.5	16	5.9	1.9	275
			2.0	14	7.5	2.4	348
			3.0	11	11.5	3.5	507
200	203.2	8"	1.5	16	8.0	1.4	203
			2.0	14	10.0	1.7	246
			3.0	11	15.3	2.6	377
250	254.0	10"	2.0	14	12.7	1.4	203
			3.0	11	19.1	2.1	304
300	304.8	12"	2.0	14	15.2	1.1	159
			3.0	11	22.8	1.7	246
			4.0	8	30.6	2.4	348
350	355.6	14"	2.0	14	17.8	1.0	145
			3.0	11	26.7	1.5	217
			4.0	8	35.6	2.0	290
400	406.4	16"	2.0	14	20.8	0.8	116
			3.0	11	31.2	1.3	188
			4.0	8	40.7	1.7	246
450	457.2	18"	2.0	14	22.9	0.7	101
			3.0	11	34.4	1.2	174
			4.0	8	45.8	1.5	217
500	508.0	20"	2.0	14	25.0	1.4	203
			3.0	11	36.5	1.1	159
			4.0	8	50.5	1.4	203
600	609.6	24"	3.0	11	45.5	0.9	130
			4.0	8	60.5	1.2	174
750	762.0	30"	3.0	11	59.0	1.4	203
			4.0	8	77.0	1.8	261

### TOLERANCES

- Diameter – Maximum  $\pm 0.75\%$
- Length – Standard lengths – 6 metres + 10 mm/–00 mm (Lengths up to 10 metres available on request)
- Material – As specified: material certificates issued on request
- The Weld – Plasma arc weld, gas tungsten arc weld (low profile or wire filled)
- Protection – Each length inspected prior to complete immersion to chemically descale and passivate the internal and external surfaces of the pipe
- Packaging – Either loose or securely strapped on pallets – end bung protection available
- Testing – When negotiated to BS3605 SW (i.e. Radiography Tensile test, etc)

**AVAILABLE IN OUTSIDE DIAMETERS ON REQUEST**

# STAINLESS STEEL HANDRAIL ACCESSORIES

## HANDRAIL BRACKETS



- Handrail brackets available with 1/2" stems, made from T304 stainless steel. Available in T316 to order.
- Available as complete units or as components.
- Saddles suit 38.1, 44.5, or 50.8mm OD stainless steel tube (riveted or welded), or with timber rails (woodscrews).

## END CAPS

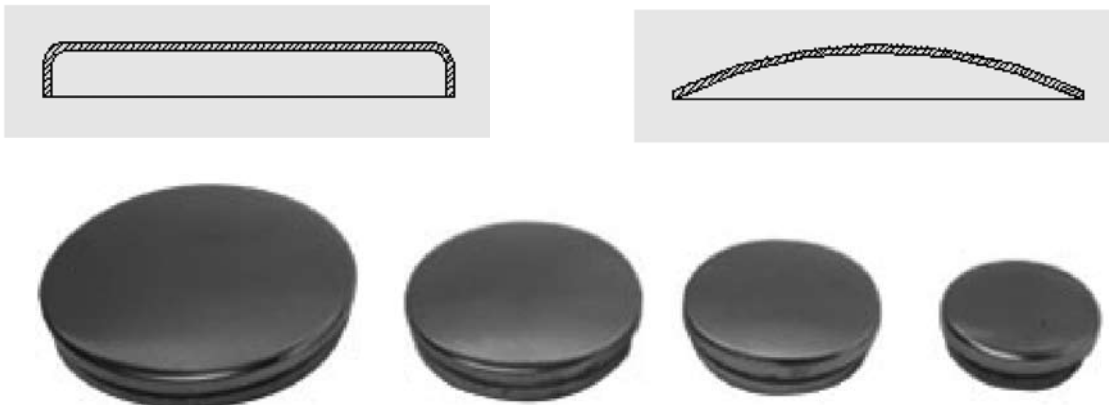

- Shallow and Deep Domed Pressed End Caps are available to suit 25.4 – 152.4mm OD tube. Shallow Domes T304 / T316 , Deep Domes T316 only.
- Push-fit End Caps are available from 19.0 – 50.8mm, to order.

## BASE PLATES / BLANKS

- 70mm diameter base

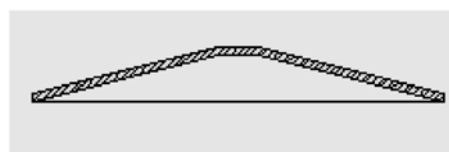

ARCHITECTURAL / STRUCTURAL TUBE ALSO AVAILABLE SEE PAGE C3

# STAINLESS STEEL WELDING BENDS

New Zealand Dimensions – Refer Page C7



OD	ID	WALL THICKNESS	90° WELD BENDS			90° SHORT RADIUS BENDS		90° LONG LEG BENDS	45° WELD BENDS		180° WELD BENDS	
			2205	304	316	304	316	304	304	316	304	306
12.7		1.2		•	•						•	
12.7		1.5/1.6			•							
16.0		1.2		•								
16.0		1.5/1.6		•								
19.0		1.2		•	•							
19.0		1.5/1.6		•	•							
25.4		1.2		•	•	•			•		•	
25.4		1.5/1.6	•	•	•	•	•		•	•	•	•
31.8		1.2		•		•		•	•		•	
31.8		1.5/1.6		•	•	•			•	•	•	•
38.0		1.2		•	•			•	•			
38.0		1.5/1.6	•	•	•	•	•		•	•	•	•
44.5		1.5/1.6		•	•				•	•	•	•
51.0		1.2		•	•			•	•			
51.0		1.5/1.6	•	•	•	•	•		•	•	•	•
63.5		1.2						•				
63.5		1.5/1.6	•	•	•	•	•		•	•	•	
76.1		1.5/1.6	•	•	•	•	•		•	•	•	•
101.6		1.6	•	•	•	•	•		•	•	•	
	125.0*	2.0			•L							
	152.4*	2.0		•L	•L							
152.4*		2.0		•L	•L				•	•		
	203.2*	2.0			•L*							
203.2*		2.0		•L								
254.0*		2.0		•L								
	254.0*	2.0		•L								
	304.8*	2.0		•L	•L							

L = TYPE 'L' – LOW CARBON STANDARD BENDS: DIMENSIONS REFER TO PAGE C7  
 \* ABE PRESSED ELBOWS DIMENSIONS – REFER TO PAGES C8 AND C9

**PRODUCT RANGE SUBJECT TO CHANGE WITHOUT NOTICE**

## DIMENSIONS OF 45°, 90°, 180° BENDS

TABLE 1 – NEW ZEALAND

OD SIZE		GAUGE	R	A	B
(mm)	(imp)				
12.7	1/2	1.2	25.4	44.5	19.1
15.9	5/8	1.2	25.4	57.2	31.8
19.1	3/4	1.2/1.6	34.9	63.5	28.6
25.4	1	1.2/1.6	44.5	66.7	22.2
31.8	1 1/4	1.2/1.6	57.2	88.9	31.8
38.1	1 1/2	1.2/1.6	76.2	111.1	34.9
44.5	1 3/4	1.2/1.6	79.4	117.5	38.1
50.8	2	1.2/1.6	101.6	133.4	31.8
63.5	2 1/2	1.6	114.3	152.4	38.1
76.2	3	1.6	139.7	177.8	38.1
101.6	4	1.6	152.4	117.8	25.4
152.4	6	2.0	228.6	260.4	31.8

**NOTE:** For 180° bends dimension 'R' specified above may vary slightly due to the variation in temper of mill supplied tube. Where dimension 'R' is critical, for intended use, please consult Corus Metals to determine the exact dimension, when ordering.

## DIMENSIONS OF 90° SHORT RADIUS

TABLE 2 – NEW ZEALAND

NOMINAL OD SIZE		GAUGE	R	D	B
(mm)	(imp)				
25.4	1	1.6	38.1	51 x 51	0.0
31.8	1 1/4	1.6	47.6	76 x 76	12.7
38.1	1 1/2	1.6	57.2	71 x 71	-4.8
50.8	2	1.6	76.2	101 x 101	0.0
63.5	2 1/2	1.6	101.6	133 x 133	0.0
76.2	3	1.6	114.3	165 x 165	12.7
101.6	4	1.6	152.4	216 x 216	12.7

### 90° Short Radius New Zealand Dimensions

For dimensions refer to Table 2

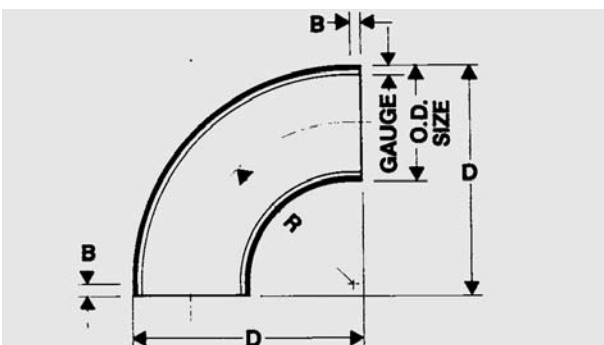

## BENDS

### 90° New Zealand Dimensions

For dimensions R, A and B, refer to Table 1

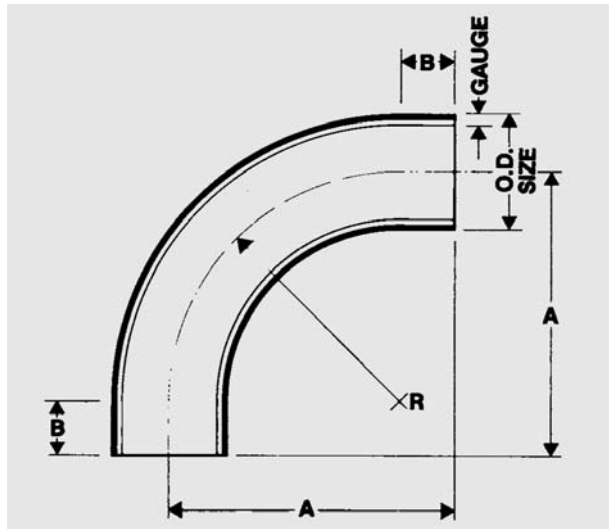

### 45° New Zealand Dimensions

For dimensions R and B, refer to Table 1

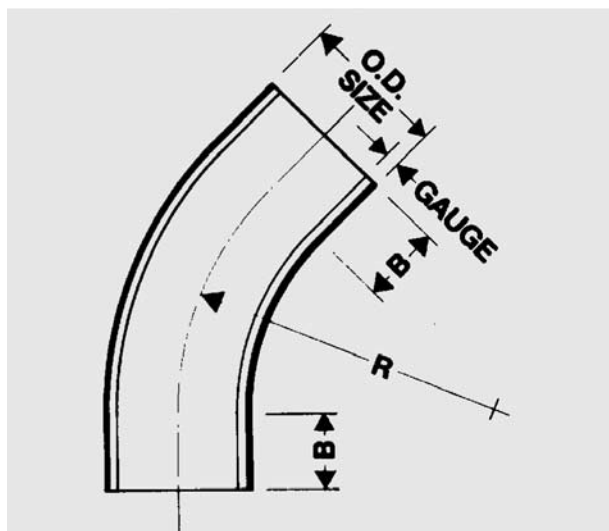

### 180° New Zealand Dimensions

For dimensions R, A and B, refer to Table 1

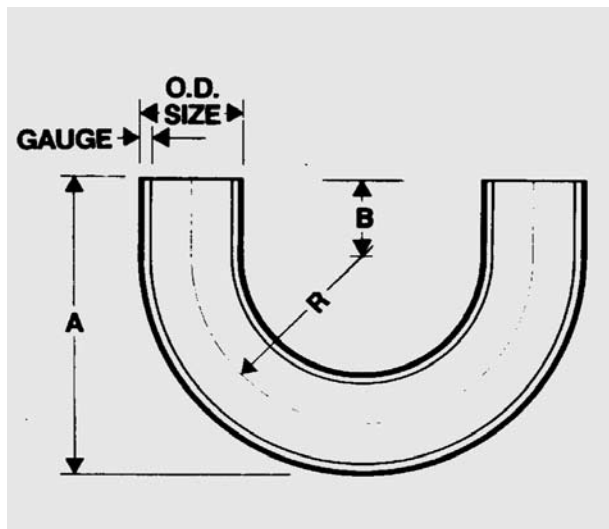

# STAINLESS STEEL BUTT WELD FITTINGS

Standard grades AISI 304L, 316L



## PRESSED ELBOWS I.D.

RADIUS 1.5 X I.D.

### 90° ELBOWS

I.D.	I.D.		A		T		WEIGHT	
	inch	mm	inch	mm	ga.	mm	lbs	kgs
1 1/2	1.500	38.1	2 1/4	57	14	2.00	.31	.14
2	2.000	50.8	3	76	14	2.00	.75	.39
2 1/2	2.500	63.5	3 3/4	95	14	2.00	1.10	.50
3	3.000	76.2	4 1/2		14	2.00	2.00	.90
4	4.000	101.6	6		14	2.00	3.00	1.24
					11	3.18	4.36	1.98
*5	5.000	125.0	7 1/2		14	2.00	4.48	2.00
*6	6.000	152.4	9		14	2.00	7.60	3.43
					11	3.18	10.00	4.52
*8	8.000	203.2	12		14	2.00	11.25	5.09
					11	3.18	17.20	7.80
					10	3.60	19.00	8.58
*10	10.000	254	15		14	2.00	16.85	7.64
					12	2.78	23.00	10.39
					11	3.18	26.00	11.74
					10	3.60	30.64	13.90
*12	12.000	304.8	18		14	2.00	26.50	11.97
					12	2.78	33.50	15.12
					11	3.18	39.31	17.83
					10	3.60	41.50	18.75
14	14.000	355.6	21		12	2.78	47.62	21.60
					11	3.18	53.00	23.94
					10	3.60	55.00	24.85
					.156	4.00	68.10	30.89
					.188	4.78	78.00	35.23
16	16.000	406.4	24		12	2.78	61.16	27.74
					11	3.18	67.00	30.25
					10	3.60	78.04	35.40
					.188	4.78	106.00	47.87
					.250	6.35	137.57	62.40
18	18.000	457.2	27		11	3.18	94.00	42.45
					10	3.60	111.00	50.13
					.188	4.78	125.00	56.45
					.250	6.35	169.80	77.02
20	20.000	508	30		11	3.18	108.25	49.10
					10	3.60	121.70	55.20
					.188	4.78	160.94	73.00
					.250	6.35	215.66	97.82
24	24.000	609.6	36		10	3.60	175.27	79.50
					.188	4.78	231.93	105.20
					.250	6.35	308.65	140.00

\* = STOCK SIZES NB 5" ONLY T316L. OTHER SIZES AVAILABLE ON INDENT



OTHER PRODUCTS AVAILABLE ON REQUEST  
 IPS PRESSED ELBOWS  
 I.D., O.D., IPS TEES  
 I.D., O.D., IPS CONCENTRIC AND ECCENTRIC REDUCERS

# STAINLESS STEEL BUTT WELD FITTINGS

Standard grades AISI 304L, 316L



## PRESSED ELBOWS O.D.

RADIUS 1.5 X O.D. (INDENT ONLY)

### 90° ELBOWS

O.D.	O.D.		A		T		WEIGHT	
	inch	mm	inch	mm	ga.	mm	lbs	kg
3	3.00	76.2	4 1/2	114	14	2.00	1.75	.79
4	4.00	101.6	6	152	14	2.00	3.00	1.36
					12	2.78	4.00	1.81
6	6.00	152.4	9	228	14	2.00	6.20	2.80
					12	2.78	9.25	4.20
8	8.00	203.2	12	305	14	2.00	10.60	4.80
					11	3.18	16.25	7.36
					10	3.60	19.00	8.62
10	10.00	254	15	381	14	2.00	18.00	8.16
					12	2.78	23.10	10.48
					11	3.18	26.50	12.02
					10	3.60	29.80	13.52
12	12.00	304.8	18	457	14	2.00	22.50	10.19
					12	2.78	33.40	15.15
					11	3.18	38.20	17.33
					10	3.60	43.10	19.55
14	14.00	355.6	21	533	12	2.78	43.00	19.47
					11	3.18	51.00	23.00
					10	3.60	54.00	24.45
					.156	4.00	65.00	29.48
					.188	4.76	74.00	33.50
16	16.00	406.4	24	610	12	2.78	63.00	25.52
					11	3.18	68.00	30.84
					10	3.60	75.50	34.18
					.165	4.20	90.00	40.82
					.188	4.78	97.00	43.92
18	18.00	457.2	27	686	11	3.18	82.00	37.14
					10	3.60	98.00	44.45
					.165	4.20	116.00	52.53
					.188	4.78	129.00	58.51
20	20.00	508	30	762	11	3.18	107.00	48.53
					10	3.60	120.00	54.43
					.188	4.78	160.00	72.57
					.218	5.54	185.00	83.91
					.250	6.32	212.00	96.16
24	24.00	609.6	36	914	10	3.60	173.00	78.47
					.188	4.78	231.00	104.78
					.218	5.54	267.00	121.11
					.250	6.35	306.00	138.80



OTHER PRODUCTS AVAILABLE ON REQUEST  
 IPS PRESSED ELBOWS  
 I.D., O.D., IPS TEES  
 I.D., O.D., IPS CONCENTRIC AND ECCENTRIC REDUCERS

# STAINLESS STEEL TUBE REDUCER

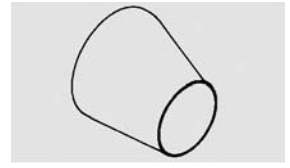
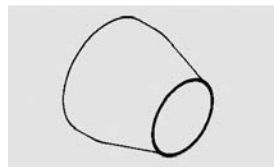
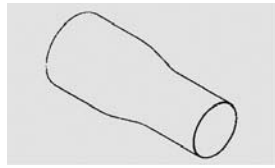

SIZE (mm)	CONCENTRIC				ECCENTRIC	
	316 EXT. LEG	304*	316	2205	304*	316
19.0 – 12.7 x 1.6			•			
25.4 – 12.7 x 1.6			•			
25.4 – 19.0 x 1.6			•			
31.8 – 25.4 x 1.6	•		•			
38.0 – 25.4 x 1.6			•	•		•
38.0 – 31.8 x 1.6	•		•			
51.0 – 25.4 x 1.6			•	•		•
51.0 – 38.0 x 1.6	•		•	•		•
63.5 – 38.0 x 1.6			•			•
63.5 – 51.0 x 1.6			•	•		•
76.1 – 25.4 x 1.6			•			
76.1 – 38.0 x 1.6			•			
76.1 – 51.0 x 1.6			•	•		•
76.1 – 63.5 x 1.6			•	•		•
101.6 – 51.0 x 1.6			•			
101.6 – 63.5 x 1.6			•			•
101.6 – 76.1 x 1.6			•	•		•
152.4 – 101.6 x 1.6			•	•		•

\* On request

# STAINLESS STEEL WELDING TEES

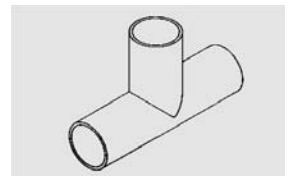
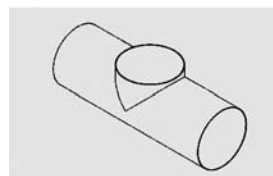
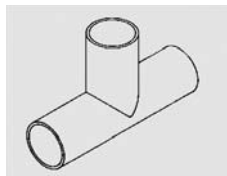

SIZE (mm)	STANDARD TEES		SWEPT TEES
	304	316	316
12.7 x 1.6		•	
16.0 x 1.2	•		
16.0 x 1.6		•	
19.0 x 1.6	•	•	
25.4 x 1.6	•	•	•
31.8 x 1.6	•	•	•
38.0 x 1.6	•	•	•
44.5 x 1.6		•	•
51.0 x 1.6	•	•	•
63.5 x 1.6	•	•	•
76.1 x 1.6	•	•	•
101.6 x 1.6	•	•	•
152.4 x 1.5	•	•	

SIZE (mm)	AS DRAWN			LONG LEG TEE	
	304	316	2205	304	316
25.4 x 1.6		•	•		
31.8 x 1.6		•		•	•
38.0 x 1.2					•
38.0 x 1.6		•	•	•	•
51.0 x 1.6		•	•	•	
63.5 x 1.6		•	•	•	
76.1 x 1.6		•	•		
101.6 x 1.6		•	•		
152.4 x 2.0		•			

**AS DRAWN REDUCING TEES  
ALSO AVAILABLE**

OTHER SIZES AVAILABLE ON REQUEST  
I/D SIZES AVAILABLE ON REQUEST  
NOTE: When necessary thickness of material may alter  
TUBE CROSS X "Y" PIECE FITTINGS AVAILABLE

# STAINLESS STEEL TRI-CLAMP FITTINGS

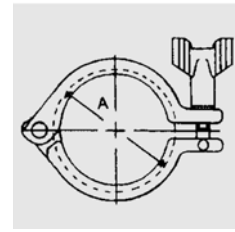

## HEAVY DUTY CLAMPS (3A-MHH)

	SIZE (OD) mm								
	12.7	19.0	25.4	38.1	50.8	63.5	76.1	101.6	152.4
A	28.2	28.2	53.9	53.9	66.5	80.9	94.4	122.4	170.0

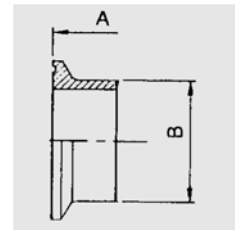

## BUTT WELDING FERRULE (3A-14 MMP)

	SIZE (OD) mm								
	12.7	19.0	25.4	38.1	50.8	63.5	76.1	101.6	152.4
A	21.5	21.5	21.5	21.5	21.5	21.5	21.5	21.5	21.5
B	12.7	19.0	25.4	38.1	50.8	63.5	76.1	101.6	152.4

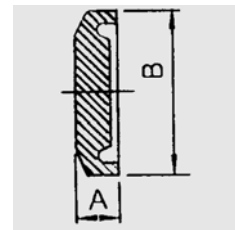

## SOLID END CAP (3A-16 AMP)

	SIZE (OD) mm								
	12.7	19.0	25.4	38.1	50.8	63.5	76.1	101.6	152.4
A	5.0	5.0	6.4	6.4	6.4	6.4	6.4	7.9	11.0
B	25.2	25.2	50.4	50.4	63.9	77.4	90.9	118.9	167.0

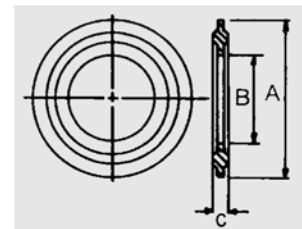

## SEAL (EPDM)

	SIZE (OD) mm								
	12.7	19.0	25.4	38.1	51.0	63.5	76.1	101.6	152.4
A	21.8	21.8	50.4	50.4	63.9	77.4	90.9	118.9	167.0
B	9.9	16.3	22.2	34.9	47.5	60.2	72.9	97.4	147.0
C	5.15	5.15	5.15	5.15	5.15	5.15	5.15	5.15	5.15

# STAINLESS STEEL DAIRY FITTINGS

Manufactured to BS 1804, 1134 and A1528

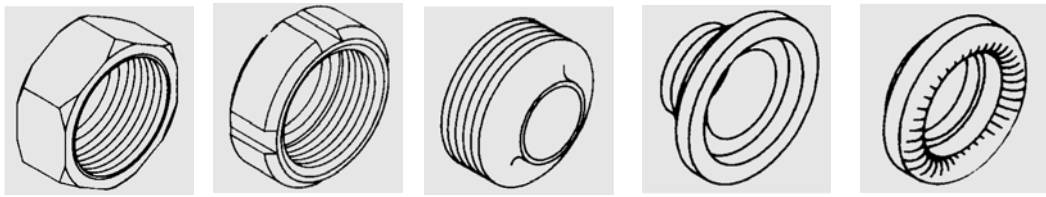

	HEX NUT	ROUND NUT	MALE PART	C.I.P. WELD LINER	C.I.P. SEAL
25.4 mm	•	•	•	•	•
38.0 mm	•	•	•	•	•
51.0 mm	•	•	•	•	•
63.5 mm	•	•	•	•	•
76.1 mm	•	•	•	•	•
101.6 mm	•	•	•	•	•
152.4 mm		•	•	•	•

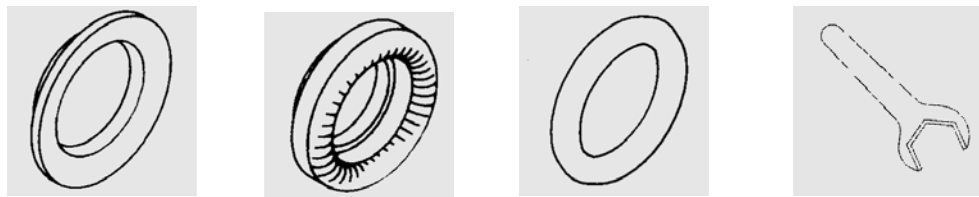

	BLANK	TEFLON SEAL	"O" RING	HEX SPANNER
25.4 mm	•	•	•	•
38.0 mm	•	•	•	•
51.0 mm	•	•	•	•
63.5 mm	•	•	•	•
76.1 mm	•	•	•	•
101.6 mm	•	•	•	•
152.4 mm	•	•	•	

25mm – 101 mm ROUND NUT  
"C" SPANNER

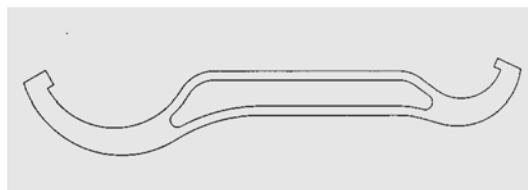

FOR DIMENSIONS SEE OVER

# TECHNICAL DATA

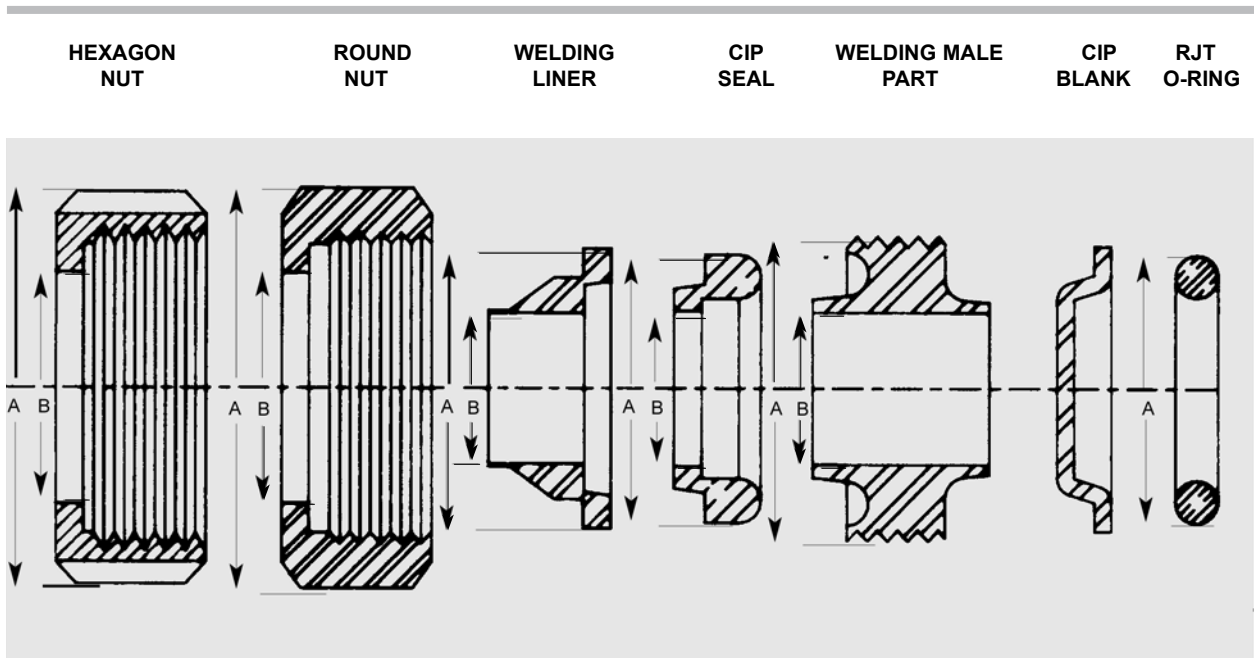

TUBE SIZE	HEX NUT STAINLESS STEEL TYPE 304		ROUND NUT STAINLESS STEEL TYPE 304		WELDING LINER STAINLESS STEEL TYPE 316		C.I.P. SEAL NITRILE RUBBER		MALE PART STAINLESS STEEL TYPE 316		RJT SEAL NITRILE RUBBER "O" RING
	A	B	A	B	A	B	A	B	A	B	A
1"	58.00	34.00	56.80	34.00	41.27	22.00	39.67	22.90	45.72	22.00	39.67
1 1/2"	75.00	46.60	73.80	46.60	53.90	34.84	52.40	34.84	58.12	34.84	52.40
2"	92.00	59.40	85.60	59.40	66.67	47.60	65.10	46.76	72.42	47.60	65.10
2 1/2"	108.00	73.20	97.10	73.20	79.50	60.05	77.80	59.40	85.12	60.05	77.80
3"	121.00	84.40	111.50	84.40	92.07	73.00	90.50	72.10	97.82	73.00	90.50
4"	152.00	110.10	139.00	110.10	117.47	98.40	115.90	97.50	123.20	98.40	115.90
6"			200.00	162.80	167.50	147.50			173.20	147.50	173.20

# STAINLESS STEEL TUBE HANGERS



SIZE mm	PLAIN *	BOSS 5/8*	SLIDE	NEVA SLIP BOSS *1	NEVA SLIP SLIDE 1	N.B. PLAIN *	N.B. BOSS *
12.7	•						
19.0	•					•	•
25.4	•	•	•	•		•	•
31.8	•	•	•	•		•	•
38.0	•	•	•	•	•	•	•
51.0	•	•	•	•	•	•	•
63.5	•	•	•	•	•	•	•
76.1	•	•	•	•	•	•	•
101.6	•	•	•	•	•	•	•
152.4	•	•	•				

\* Can also be supplied with M10 + M12 threaded boss 1. New Zealand application No. 245763



SIZE mm	MUNSON RING	TOGGLE CLAMP	BOSLOK CLAMP	
19.0	•		•	
25.4	•	•	•	
31.8		•	•	
38.0	•	•	•	
51.0	•	•	•	
63.5		•	•	
76.1		•	•	
101.6		•	•	

**DELIVERY LINE HANGER BRACKET**

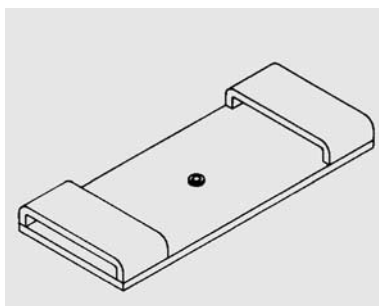

**NEVA SLIP BOSS WALLMOUNT BRACKET AND BOSS ADAPTOR TO SUIT M10 AND M12**

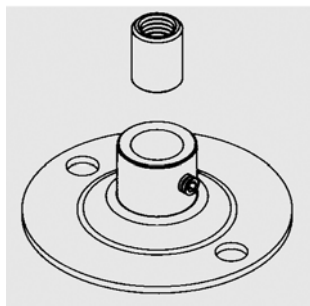

**BOSLOK WALL BRACKET**

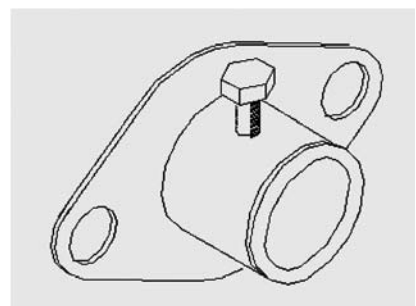

# EXPANSION FLANGES

Corus New Zealand Limited

A purpose designed seal for wall, floor and ceiling penetrations of process piping in food and beverage plants or any applications where a waterproof hygienic seal is required.

Design allows for lineal expansion and contraction of pipework whilst maintaining an intrinsic seal to prevent ingress or water etc. to penetrated material. (See detail 1).

The flange can also be adapted to accommodate Steam Pipe or Non-Standard tube diameters by adding a Teflon or heat resistant liner. (See detail 2).

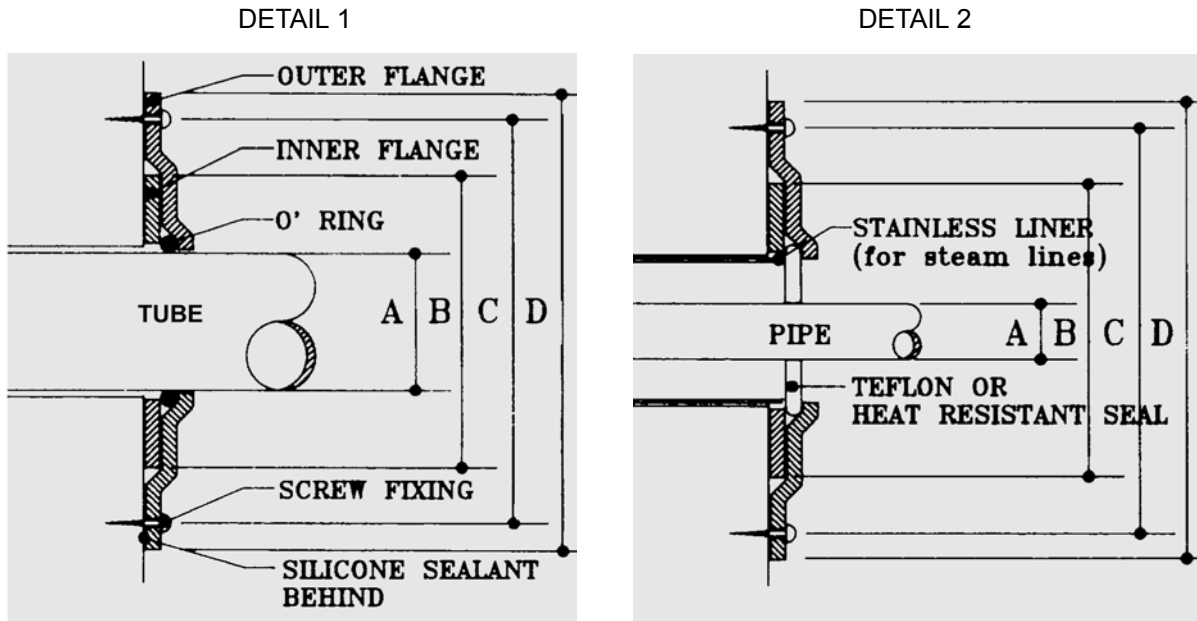

## Standard Sizes (Dimensions mm)

TUBE O.D.	A	B	C	D
12.7	14.7	53	70	86
19.0	21.0	53	70	86
25.4	27.4	53	70	86
31.8	33.8	85	103	118
38.0	40.0	85	103	118
44.5	46.5	85	103	118
51.0	53.0	85	103	118
63.5	65.5	118	130	140
76.1	78.1	118	130	140
101.6	103.6	140	158	180
129.0	119.0	216	198	216
152.0	140.0	216	198	216

NEW ZEALAND PATENT No. 226079



## Tata Steel International (Australasia) Ltd

---

<b>Head Office</b>	7 Bruce Roderick Drive East Tamaki Phone 09 271 1780	PO Box 58880, Botany, Manukau 2163 Fax 09 271 1970 Email: <a href="mailto:headoffice@tatasteelnz.com">headoffice@tatasteelnz.com</a>
<b>Auckland</b>	7 Bruce Roderick Drive East Tamaki Phone 09 271 1781	PO Box 58880, Botany, Manukau 2163 Fax 09 271 1799 Email: <a href="mailto:auckland@tatasteelnz.com">auckland@tatasteelnz.com</a>
<b>Mt Maunganui</b>	18 MacDonald Street Phone 07 574 0095	PO Box 4158, Mt Maunganui South 3149 Fax 07 574 0096 Email: <a href="mailto:tauranga@tatasteelnz.com">tauranga@tatasteelnz.com</a>
<b>Hamilton</b>	27 Ellis Street, Frankton Phone 07 847 8456	PO Box 1133, Waikato Mail Centre 3240 Fax 07 847 0354 Email: <a href="mailto:hamilton@tatasteelnz.com">hamilton@tatasteelnz.com</a>
<b>Hastings</b>	807 Warren Street Phone 06 876 3360	PO Box 14043, Mayfair, Hastings 4159 Fax 06 876 3411 Email: <a href="mailto:hastings@tatasteelnz.com">hastings@tatasteelnz.com</a>
<b>New Plymouth</b>	Cnr Connett Road & Mustang Drive, Bell Block Phone 06 759 9382	PO Box 3094, Fitzroy New Plymouth 4341 Fax 06 755 7575 Email: <a href="mailto:newplymouth@tatasteelnz.com">newplymouth@tatasteelnz.com</a>
<b>Wellington</b>	141 Hutt Park Road Phone 04 568 5014	PO Box 38065, Lower Hutt 5045 Fax 04 568 6367 Email: <a href="mailto:wellington@tatasteelnz.com">wellington@tatasteelnz.com</a>
<b>Nelson</b>	4C Akersten Street Phone 03 548 0603	PO Box 413, Nelson 7040 Fax 03 548 0588 Email: <a href="mailto:nelson@tatasteelnz.com">nelson@tatasteelnz.com</a>
<b>Christchurch</b>	200 Maces Road, Bromley Phone 03 381 1994	P O Box 570, Christchurch Mail Centre 8140 Fax 03 381 0606 Email: <a href="mailto:christchurch@tatasteelnz.com">christchurch@tatasteelnz.com</a>

---

**Toll free: 0800 4 26787**

**Website: [www.tatasteelnz.com](http://www.tatasteelnz.com)**

Care has been taken to ensure that the contents of this publication are accurate but Tata Steel International do not accept responsibility for errors or for information which is found to be misleading. Suggestions for or descriptions of the end-use or application of products or methods of working are for information only and the company accepts no liability in respect thereof. Before using products supplied or manufactured by the company the customer should satisfy themselves of their suitability. If further assistance is required the company which has extensive research facilities will often be able to help.